

The Company uses 90°C conductors and cannot terminate on the main disconnect. NEC 110.14

Hinged double doors with hasp for the Company padlock

Location where utility-supplied CTs will be installed

42"

1-1/2" Max.

40"

Minimum Depth 24"

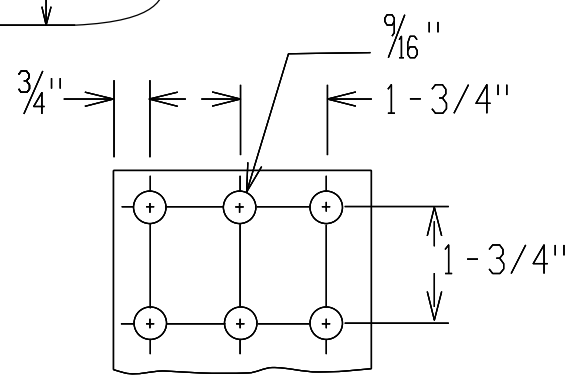

6 Hole Lug Pads Over 1200 Ampere

Contact the Company for approval on these installations.

Instrument meter socket to be located outside and within 25 feet of CT cabinet. The conduit between the meter socket and CT cabinet shall be min. 1 1/4" diameter.

Revised: 03/10